



City of Plantation
 Planning, Zoning and Economic Development Department

Mock Boundary Survey:

All new trees/palms will be Florida #1 grade or better.

Acquired Utility line locations by calling 811 Dig & show Power lines on survey.

Coconut palm shall not be utilized for replacement.

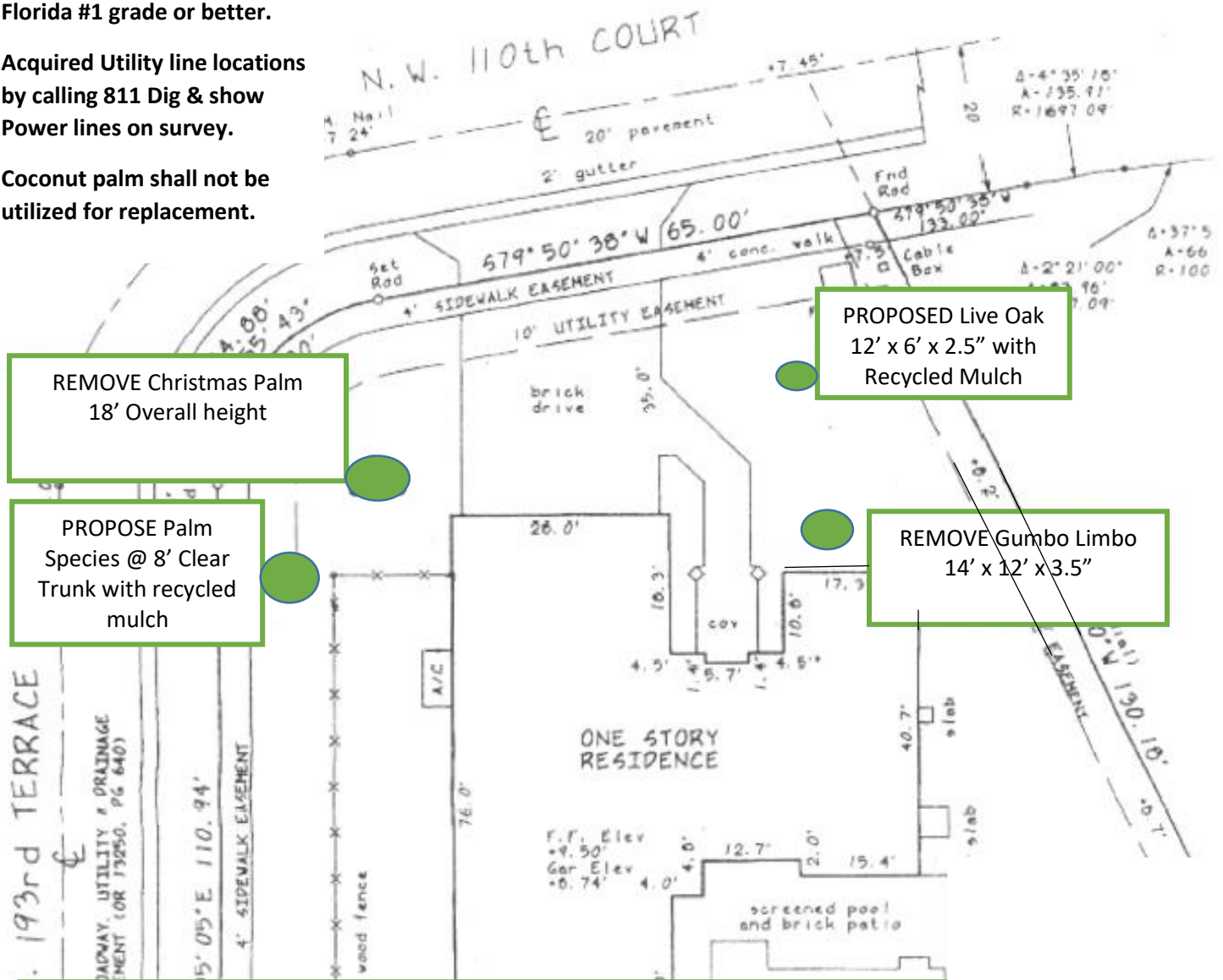

REMOVE Christmas Palm
 18' Overall height

PROPOSE Palm
 Species @ 8' Clear
 Trunk with recycled
 mulch

PROPOSED Live Oak
 12' x 6' x 2.5" with
 Recycled Mulch

REMOVE Gumbo Limbo
 14' x 12' x 3.5"

- Ensure that the property is lot compliant by showing Existing trees/palms with dimensions (or) propose additional trees to suffice.
- SFR under ¼ acre requires 3 trees (1 min in front)
 - SFR over ¼ acre requires 4 trees (2 min in front)
 - SFR within RS1-EP zone district under 40k sf. require 6 trees in front half of property
 - SFR within RS1-EP zone district over 40k sf. Require 8 trees in front half of property
- *Three palms may substitute 1 Code required tree – in one instance
 *An Existing Fruit tree with canopy over 30' may substitute 1 Code required tree – in one instance.